

6

5

4

3

2

1

D

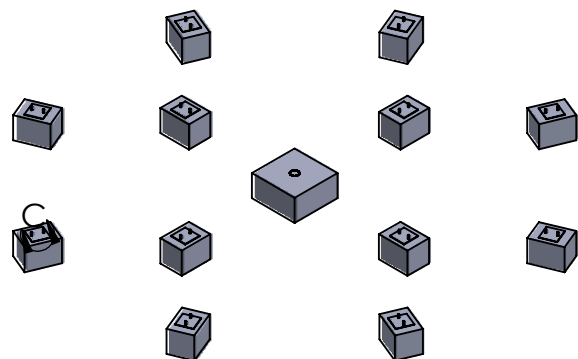

Isometric View

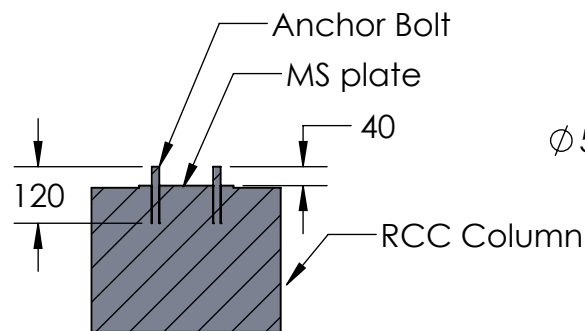

SECTION A-A
SCALE 1 : 16

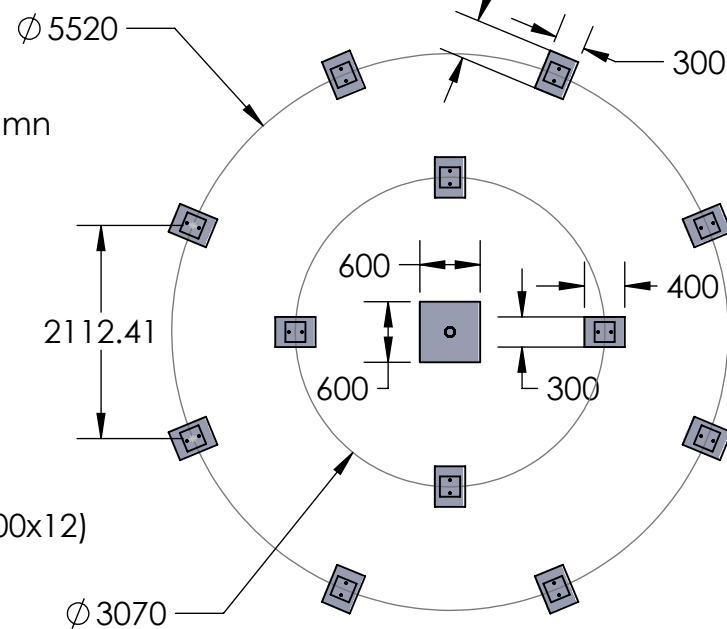

Top View

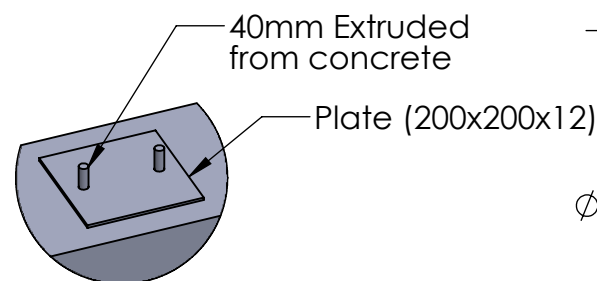

DETAIL C
SCALE 1 : 12

Remarks:

- (1) Anchor Bolt: 16mm, 120mm long
24 pc
- (2) Load should be distributed over the foundation equally.
- (3) Whole foundations top surface should be on same plane.
- (4) Recommended foundation height is 1ft from ground.

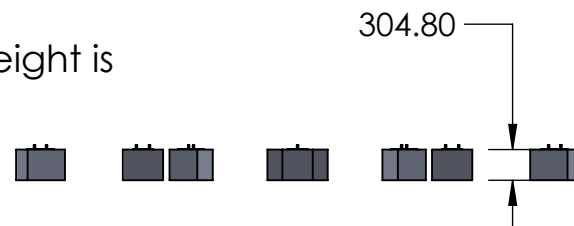

Front view

C

B

A

D

C

B

A

	NAME	SIGNATURE	DATE
DRAWN	Rahul Carnaliious Snal		
CHK'D	Md Shahed Hassan		
APPV'D	Md Shahed Hassan		
Scale 1:75	Unit : mm	MATERIAL:	
Title			A4
Foundation - ART 500			

6

5

4

3

2

1